

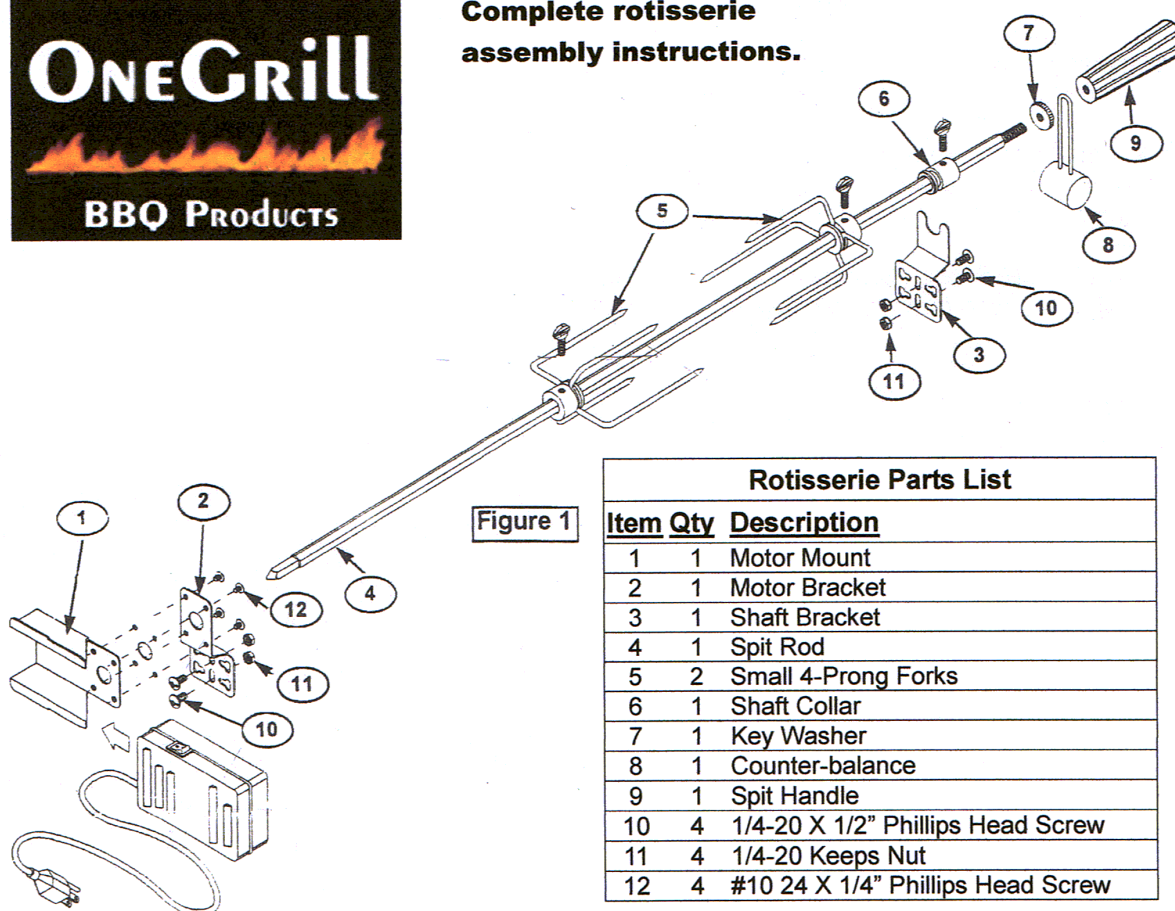

Complete rotisserie assembly instructions.



Rotisserie Parts List		
Item	Qty	Description
1	1	Motor Mount
2	1	Motor Bracket
3	1	Shaft Bracket
4	1	Spit Rod
5	2	Small 4-Prong Forks
6	1	Shaft Collar
7	1	Key Washer
8	1	Counter-balance
9	1	Spit Handle
10	4	1/4-20 X 1/2" Phillips Head Screw
11	4	1/4-20 Keeps Nut
12	4	#10 24 X 1/4" Phillips Head Screw

IMPORTANT SAFEGUARDS:

When using electrical appliances, basic safety precautions should always be followed, including the following:

1. **READ ALL INSTRUCTIONS!**
2. Do not touch hot surfaces. Use handle or knobs.
3. To protect against electrical shock, do not immerse cord or plug in water or other liquid.
4. Close supervision is necessary when appliance is used by or near children.
5. Unplug from outlet when not in use and before cleaning. Allow to cool before putting on or taking off parts.
6. Do not operate any appliance with a damaged cord or plug, or after the appliance malfunctions or has been damaged in any manner. Return appliance to the nearest authorized service facility for examination, repair, or adjustment.
7. The use of accessory attachments not recommended by the appliance manufacturer may cause injuries.
8. Do not let cord hang over edge of table or counter, or touch hot surfaces.
9. Do not place on or near a hot gas or electric burner, or in a heated oven.
10. Extreme caution must be used when moving an appliance containing hot oil or other hot liquids.
11. Always attach plug to appliance first, the plug cord into the wall outlet. To disconnect, turn any control to "OFF", then remove plug from wall outlet.
12. Do not use appliance for other than intended use.



Assembly instructions continued.

1. Assemble Motor Bracket (2), and Motor Mount (1) using four screws (12) as shown in **Figure 1**.
2. Attach Motor Bracket Assembly to side of barbecue frame (can be mounted on either the left or right side of the frame) using two screws (10), and two nuts (11) (**Figure 2**).
3. Attach Shaft Support Bracket (3) to opposite side and secure with two screws (10), and two nuts (11) (**Figure 3**).
4. Insert Rotisserie Motor onto Motor Bracket Assembly (**Figure 1**).
5. Assemble Key Washer (7), Counter-balance (8), and Handle (9) to Spit Rod (4). Slide Shaft Collar (6) with end towards handle as shown in **Figure 3**.
6. Slide Prong Forks (5) onto Spit Rod (4). Place food onto Spit Rod and secure with Prong Forks. Secure with Thumb Screws. Place Spit Rod assembly over Shaft Bracket (3) and position into Motor. Secure position with Thumbscrew.

NOTE: Close Hood carefully and align the Motor Bracket(1) and Shaft Mounting Bracket (3) so that the Rotisserie Rod is centered in the Lid openings allowing 1/16" clearance to allow Spit Rod to turn (see **Figure 4**).

7. Ensure that all Bolts are tightened securely.

NOTE: Cooking Grates are removed from Barbecue for all rotisserie cooking. (Drip Trays are recommended for use in all Rotisserie Cooking).

Thank you for choosing **ONEGrill**. Our products are designed to provide many years of service and enjoyment. They are also backed by the best warranty and service in the industry. Happy grilling!

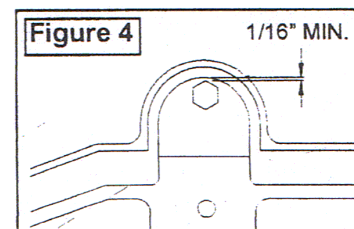
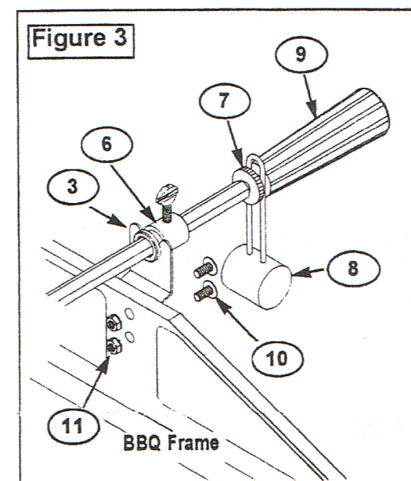
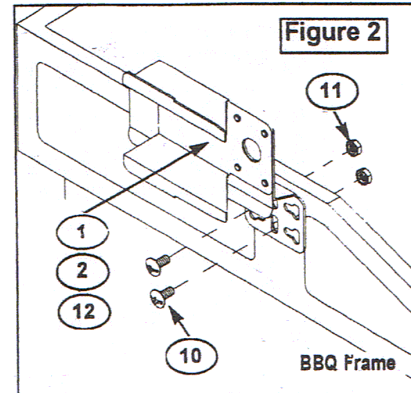

OneGrill,LLC

www.onegrill.com Maysville, Ohio 45030 support@onegrill.com